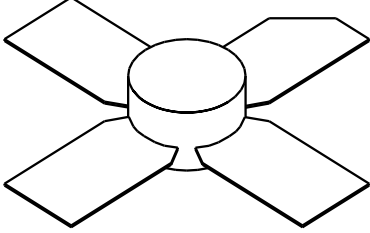

<p>GENERAL DESCRIPTION</p> <p>The 1090MP is a COMMON BASE bipolar transistor. It is designed for pulsed systems in the frequency band 1025-1150 MHz. The transistor includes input prematch for broadband capability. The device has gold thin-film metallization for proven highest MTTF. Low thermal resistance package reduces junction temperature, extends life.</p>	<p>CASE OUTLINE 55FU, STYLE 1</p> 
<p>ABSOLUTE MAXIMUM RATINGS</p> <p>Maximum Power Dissipation @ 25°C² 250 Watts Peak</p> <p>Maximum Voltage and Current</p> <p>BVces Collector to Emitter Voltage 60 Volts BVebo Emitter to Base Voltage 4.0 Volts Ic Collector Current 6.0 Amps Peak</p> <p>Maximum Temperatures</p> <p>Storage Temperature - 65 to +150 °C Operating Junction Temperature + 200°C</p>	

ELECTRICAL CHARACTERISTICS @ 25 °C

SYMBOL	CHARACTERISTICS	TEST CONDITIONS	MIN	TYP	MAX	UNITS
Pout	Broadband Power Out	F = 1025-1150 MHz	90	98		Watts
Pin	Power Input	Vcc = 50 Volts			14	Watts
Pg	Broadband Power Gain	PW = 10 μsec	8.0	8.5		d B
η_c	Collector Efficiency	DF = 1%	35	38		%
VSWR	Load Mismatch Tolerance	F = 1090 MHz			10:1	

BVebo	Emitter to Base Breakdown	Ie = 1 mA	3.5			Volts
BVces	Collector to Emitter Breakdown	Ie = 10 mA	65			Volts
Cob	Capacitance Collector to Base	Vcb = 50 V			16	pF
h_{FE}	DC - Current Gain	Ic = 500mA, Vcc = 5V	15		120	
θ_{jc}¹	Thermal Resistance	Tc = 25 °C			0.6	°C/W

Note1: At Rated Power Output and pulse conditions.

2: Maximum Ratings are for RF Amplifier Operation

Issue Aug 1996

GHz TECHNOLOGY INC. RESERVES THE RIGHT TO MAKE CHANGES WITHOUT FURTHER NOTICE. GHz RECOMMENDS THAT BEFORE THE PRODUCT(S) DESCRIBED HEREIN ARE WRITTEN INTO SPECIFICATIONS, OR USED IN CRITICAL APPLICATIONS, THAT THE PERFORMANCE CHARACTERISTICS BE VERIFIED BY CONTACTING THE FACTORY.

Pout & COL. EFF. vs COL. VOLTAGE

F=1215MHz, PW=10us, DF = 1%, Tc=25C

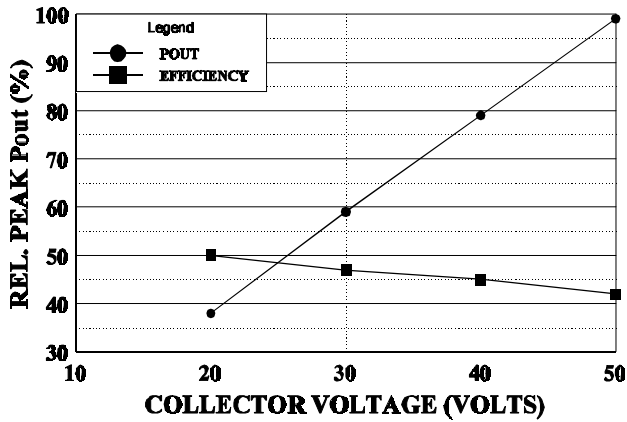

NARROWBAND PEAK Pout vs FREQUENCY

Vcc=50V, PW=10usec, DF = 1%, Tc=25 C

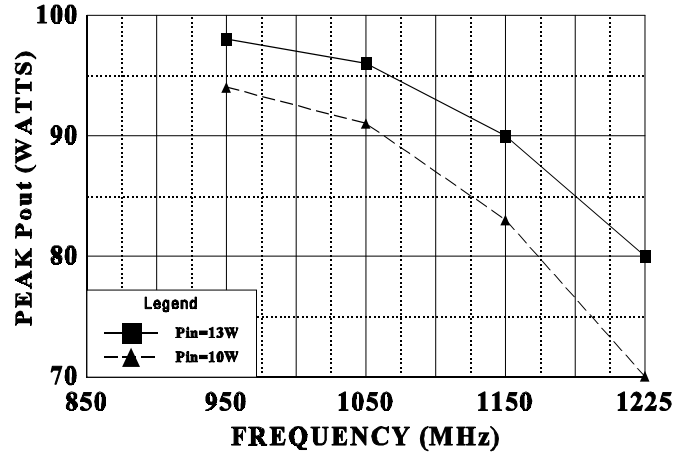

NARROWBAND COL. EFF. vs FREQ.

Vcc=50V, Pin=14 W, 10 usec / 1%

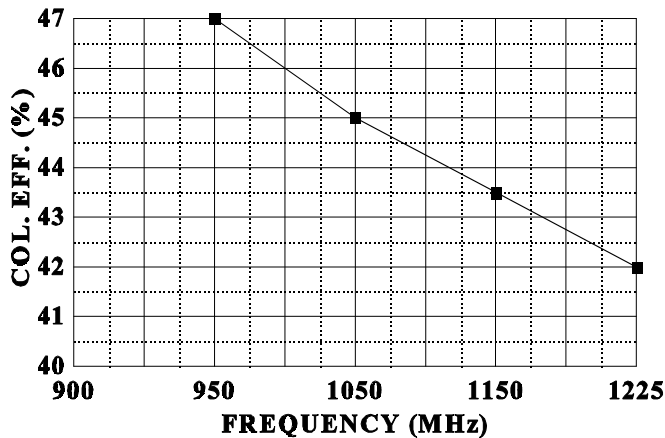

TYPICAL Pout

Vcc=50V, PW=10usec, DF = 1%, Tc =25 C

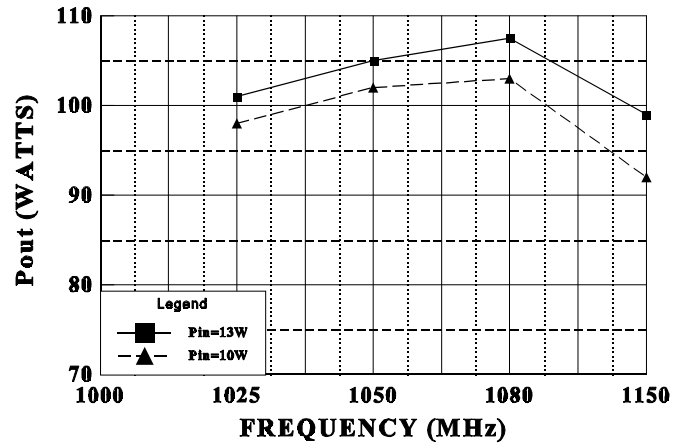

August 1996

GHZ TECHNOLOGY INC. RESERVES THE RIGHT TO MAKE CHANGES WITHOUT FURTHER NOTICE. GHZ RECOMMENDS THAT BEFORE THE PRODUCT(S) DESCRIBED HEREIN ARE WRITTEN INTO SPECIFICATIONS, OR USED IN CRITICAL APPLICATIONS, THAT THE PERFORMANCE CHARACTERISTICS BE VERIFIED BY CONTACTING THE FACTORY.

GHZ Technology Inc. 3000 Oakmead Village Drive, Santa Clara, CA 95051-0808 Tel. 408 / 986-8031 Fax 408 / 986-8120

1090MP

VCB=50V Pout= 90Watts. PW 10uS, DF=1%

	Zin		ZCL	
Frequency	R	jx	R	jx
960	4.9	12.13	8.77	14.41
1030	4.55	10.71	7.66	12.3
1090	4.41	9.65	6.93	10.59
1150	4.39	8.7	6.36	8.95
1215	4.51	7.81	5.89	7.26

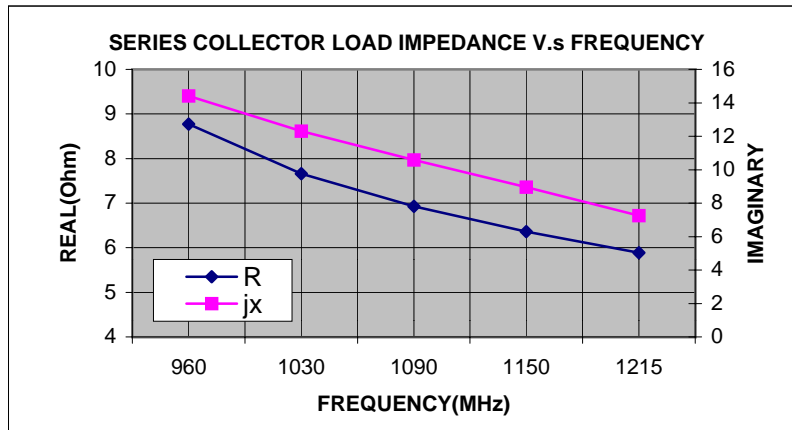
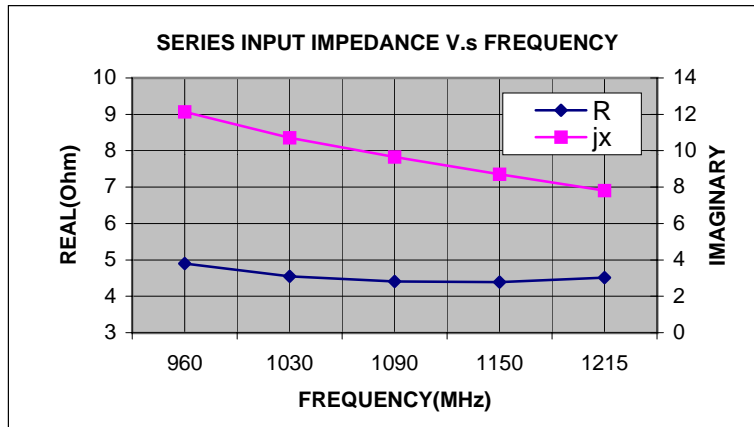

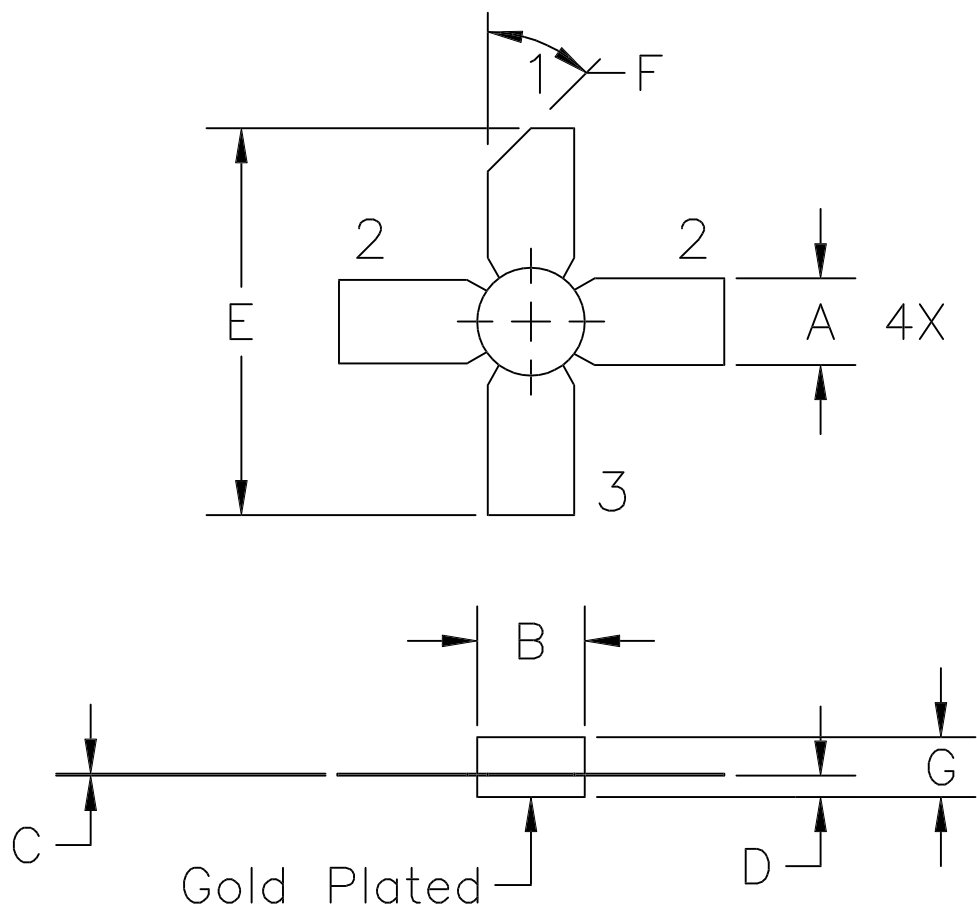

STYLE 1:
PIN1 = COLLECTOR
2 = BASE (2X)
3 = EMITTER

STYLE 2:
PIN1 = COLLECTOR
2 = EMITTER (2X)
3 = BASE

DIM	MILLIMETER	TOL	INCHES	TOL
A	5.71	.13	.225	.005
B	7.11 DIA	.13	.280 DIA	.005
C	0.13	.02	.005	.001
D	1.40	.13	.055	.005
E	25.53	.64	1.005	.025
F	45°	5°	45°	5°
G	3.94	REF	.155	REF

